

X.L. BAND W/ SPRING ASSIST INSTRUCTION MANUAL

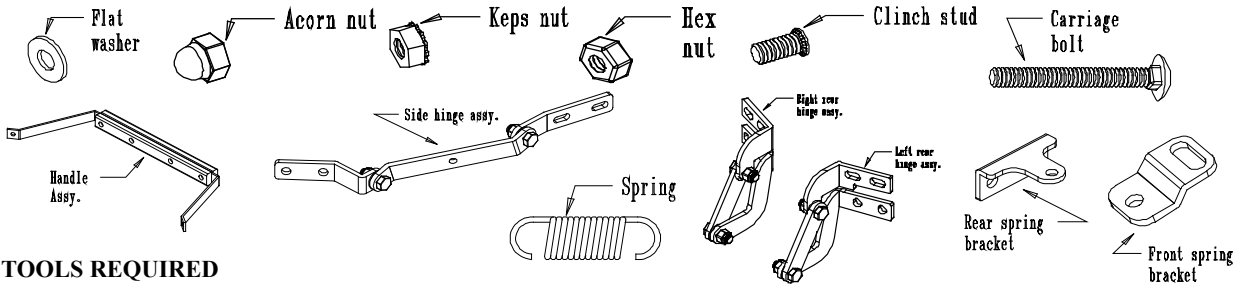

PARTS LIST

- (2) Bands (1) Handle assembly (2) Side hinge assemblies (1) Left rear hinge assembly (1) Right rear hinge assembly (2) front spring brackets (2) rear spring brackets (2) springs (4) black vinyl caps
 (1) Hardware bag: (14) 1/4" -20 x 5/8" clinch studs (4) 1/4"-20 x 3/4" clinch studs (18) 1/4"-20 keps nuts (2) 1/4"-20 x 1/2" clinch studs (2) 1/4"-20 acorn nuts (2) 5/16"-18 x 2" carriage bolts (2) 5/16" flat washers (2) 5/16"-18 hex nuts



TOOLS REQUIRED

7/16" wrench, 1/2" wrench, tape measure or ruler.

Note: All references to Left & Right in this manual are as viewed from the front (*facing the vent / draft door*) of the Egg.

STEP 1: Place the egg stand of your choosing (*optional nest or table*) on a flat & level surface. Carefully remove all the internal components from inside the egg bottom. (*Save the foam / cardboard pads that separated the egg bottom from the dome during shipping, these will be useful in step 4*) With the aid of an assistant, place the egg bottom into the stand with the lower vent door facing forward. Carefully replace all the internal components back into the egg bottom.

STEP 2: Open the hardware bag and locate the (2) 1/4"-20 x 1/2" clinch studs (*shortest two*), insert them into the handle attachment holes in the upper band, then install & hand tighten the (2) 1/4"-20 acorn nuts (**Illustration A**) (*NOTE: both bands are identical and some holes are not used, they become upper & lower bands after the hardware is installed as specified*). Install (4) 1/4"-20 x 3/4" clinch studs (*longest 4*) into the lower band as illustrated with 1/4"-20 keps nuts hand tightened to hold them in place. Install (12) 1/4"-20 x 5/8" clinch studs into the remaining positions as illustrated (**Illustration A**).

NOTE: If you are installing the optional Egg-Mate tables at this time, you will want to insert the (4) 1/4"-20 x 5/8" clinch studs (*provided with the Egg-mates*) into the lower band only (*step 1 of the Egg-Mate manual*). Some of the illustrations in this manual show the optional egg-mate clinch studs in place.

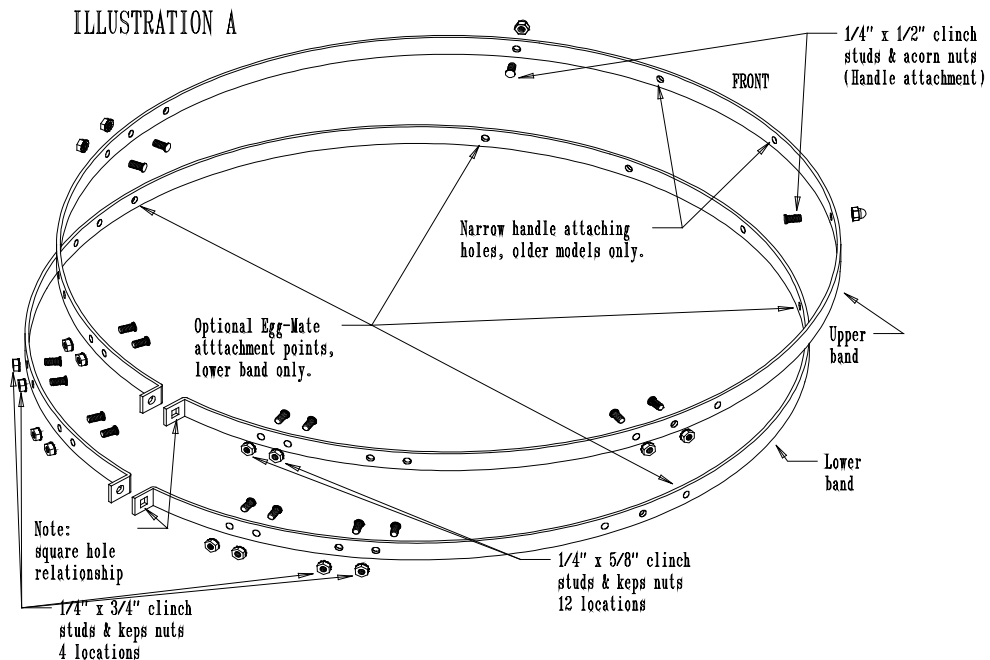

STEP 3: Install the lower band onto the egg bottom; the square hole in the flange at the end of the band should be to the left at the rear of the egg. Note, the egg bottom and dome have a locating hole on the band attachment area that indicate the front of the grill this will be centered between the handle attachment holes (*newer model bands are stamped PAT. PEND. between the handle attachment holes*) in the bands. **(Illustration B)** Insert a 5/16" x 2" carriage bolt through the square hole then the round hole in the band tensioning flanges at the rear of the egg bottom. Install a flat washer and a 5/16" hex nut and hand-tighten. Measure vertically from the top of the gasket surface to the lower edge on the band; position the band as close to 1 inch as you can **(Illustration D)** (*slightly more than 1 inch is better than less*). Do this at four points, front, rear and both sides. When you have the band set at 1 inch, proceed to tighten the 5/16" carriage bolt to approximately 125 inch lbs. (**bending of the bolt and flanges during tightening is normal / recommended. Don't fear the ceramic will not break**). After the band is securely tightened, check the 1-inch measurement once again to make sure the band didn't move upward reducing your 1-inch measurement. If the band did move and you have less than a 1-inch measurement loosen the band, reset the 1-inch measurement and tighten the band again. Check the measurement again, if it is still less than 1 inch note the measurement and proceed to step 4.

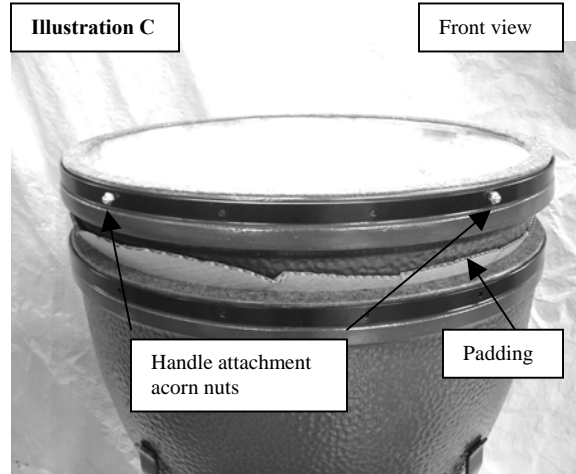
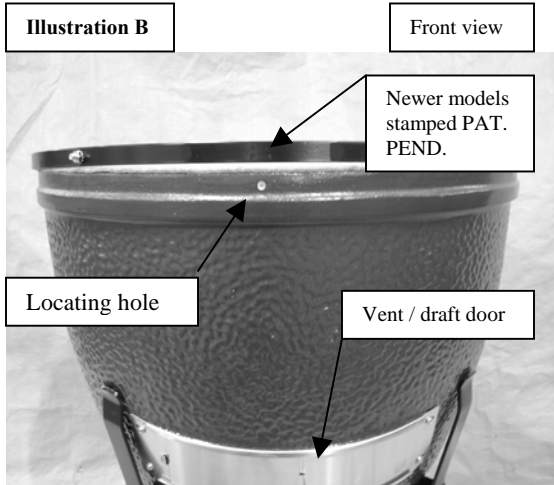
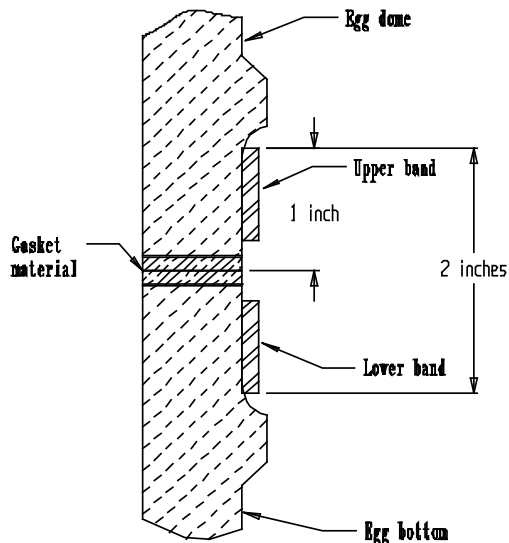

Illustration D



Egg dome & bottom section view

STEP 4: In this step you will be installing the upper band onto the egg dome. This works best with the dome supported upside-down, gravity will help you in this way. Remove the cooking grate from inside the egg bottom. Replace the cardboard / foam pads (*retained from step 1*) inside the top lip of the egg bottom. If you discarded the original pads use some other suitable thick padding to line the inside lip of the egg bottom to prevent chipping the glaze finish on the egg dome. Find the front locating hole in the band attachment area of the egg dome. With the padding in place on the egg bottom, and with the help of an assistant, carefully place the egg dome upside down inside the egg bottom with the front locating hole roughly aligned with the front of the grill bottom. **(Illustration C)** Place the upper band onto the egg dome with the square hole in the tensioning flange to the right side at the rear of the egg. (*Since the dome is upside down, this is opposite of the egg bottom band*) Position the band so the locating hole in the dome is centered left to right between the handle attachment acorn nuts. Insert a 5/16" x 2" carriage bolt through the square hole then the round hole in the band tensioning flanges at the rear of the egg dome. Install a flat washer and a 5/16" hex nut and hand-tighten.

As in step 3 adjust the band height on the dome so it measures 1 inch from the gasket surface to the lower edge on the band. If your measurement in step 3 was less than 1 inch (*i.e. your measurement was 7/8" that is 1/8" less than the 1" required*) you will want to try to increase the dome band measurement by the amount your base measurement was less than 1 inch (*i.e. 1" required + 1/8" = 1-1/8"*). Measure & adjust this at four points and tighten the 5/16" carriage bolt as you did for the egg bottom in step 3. After tightening, check your measurement again to verify it didn't change. Repeat this

process if needed to adjust the dimension as close as possible.

STEP 5: With the help of an assistant, lift the egg dome from the egg bottom and remove the padding from the inside lip of the egg bottom. Turn the egg dome upright and place it onto the egg bottom with the band tensioning flanges aligned at the rear of the egg. Remove the two handle attachment acorn nuts from the front of the upper band, slide the handle assembly onto the studs and reattach the acorn nuts (*make sure the Big Green Egg brand on the front wood cover is not upside down*) and then tighten both acorn nuts. Center the dome on the base, front to rear and left to right.

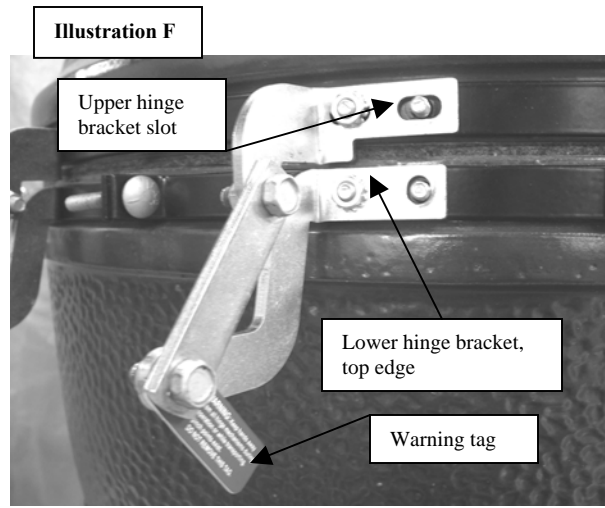
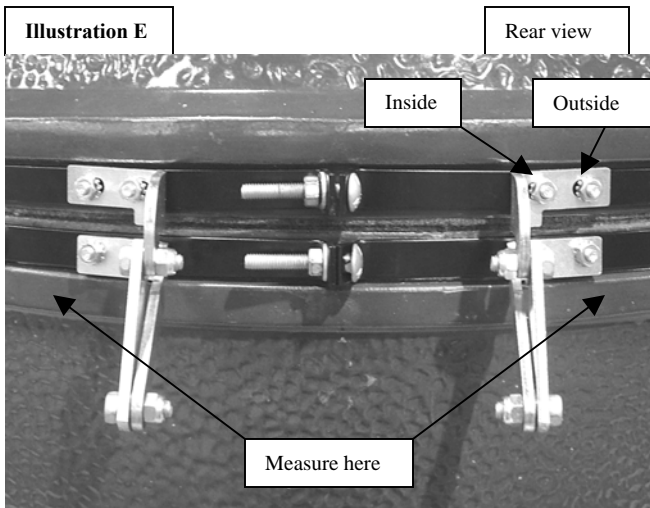

STEP 6: Remove the 8 nuts from the clinch studs for rear hinge bracket attachment. Measure the vertical distance from the top edge of the upper band to the bottom edge of the lower band (*It should be 2" plus or minus 1/16"*). Make this measurement at two places, just outside of where the rear hinge brackets will attach (**Illustrations D & E**). The rear lower hinge bracket has a small vertical slot for fine adjustment as needed.

If your measurement was $2'' + - 1/16''$ as specified in (**Illustration D**), place the hinge assembly onto the studs in both bands and position it so the top edge of the lower hinge bracket is flush / even & parallel with the top edge of the lower band. Install the nuts and tighten the inside nut first, then the outside nut, make sure the bracket doesn't move during tightening. Repeat this procedure for the opposite rear hinge assembly.

If your measurement was less than the specified 2" distance by more than 1/16" position the lower bracket downward as far as possible on the clinch studs. Install the nuts and tighten the inside nut first, then the outside nut, make sure the bracket doesn't move during tightening. Repeat this procedure for the opposite rear hinge assembly.

Look at the location of the clinch studs in relationship to the slot in the upper hinge bracket; (**Illustration F**) you may have to slightly rotate the dome to equalize the location of the studs in the left & right brackets. Install the nuts for the upper hinge brackets and securely tighten, starting with the inside nut first.

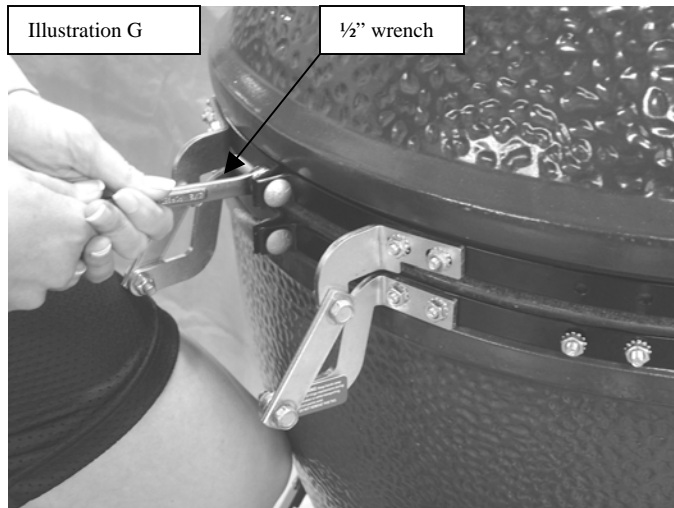

STEP 7: Make sure the dome is still centered left to right on the egg bottom. At the rear of the egg, place the closed / boxed end of your 1/2" wrench onto the band tensioning carriage bolt of the upper / dome band. Brace your knee against the egg bottom to prevent the egg bottom from moving. Firmly grasp the wrench and use it as a handle to gently pull the egg dome rearward (**Illustration G**) (*typically 1/8" to 1/4"*). The goal is to create a small gap (*1/16" to 1/8"*) between the dome and base gaskets at the rear of the egg. Remove your 1/2" wrench and proceed to the front of the egg. Grasp the dome lift handle and **slowly lift straight up, do not pull forward**, between 1/2 inch and no more than 1 inch, then lower the dome back down. (*This allows the dome to rotate forward on the hinge to the proper location on the bottom*) If you lifted the dome too far repeat step 7. Once step 7 is complete **Do Not** move the dome until instructed in step 9.

STEP 8A: Remove the 8 nuts that will attach the left & right side hinge assemblies, 4 from each band. Position the lower side hinge bracket onto the studs in the lower band. Position a rear spring bracket onto the same studs install and securely tighten the nuts. Attach a slotted front spring bracket to the inside of the side link bar using a 1/4"-20 x5/8" clinch stud through the round hole in the spring bracket then through the round hole in the side link bar and install a 1/4" nut. The slotted section of the spring bracket should overhang the edge of the side link bar facing the front of the egg. The front spring bracket is offset formed to prevent it from rotating on the link bar. (**Illustration H**) Rotate the side link bar forward into position so the upper side hinge bracket can be placed onto the studs in the upper band. Install and hand tighten the inner nut only. Repeat this for the opposite side hinge assembly. After both assemblies are in place, look at the outer slot and the stud in the upper side hinge bracket. (**Illustration I**) You need to have slot space available to allow the dome to be moved forward as needed. **If you DO NOT have the slot space required proceed to STEP 8B. If you DO have the required slot space on both sides**, install the outer nuts and tighten the upper front hinge brackets (*inner nut first*) at this time also tighten the front spring bracket nuts and **proceed to Step 9.**

Step 8B: On the rare occasion that you don't have slot space in front of the studs, this could be caused by a combination of two things. 1: The dome is somewhat larger in circumference than the bottom of the egg. *Since the metal bands are die cut / punched simultaneously they are very accurate and can be considered as a tape measure. Simply look at the gap at the*

tensioning flanges at the rear of the egg, if the dome band has a larger gap between the tensioning flanges than the bottom band the dome is larger in circumference. 2: The egg dome or the bottom could be out of round. Re-adjusting the bands can usually compensate for these conditions. By raising the upper band or lowering the lower band or lowering the lower rear hinge bracket causes the dome to have to be moved rearward. (For every 1/16" that you move either band the dome will then need to be moved rearward by 1/8"). First remove the upper side hinge brackets from the studs in the upper bands and swing the side link bars down out of the way. If you have room to move the upper band upward further or the lower band downward further please do so accordingly. Completely loosen all 8 of the rear hinge bracket to band attaching nuts and then the band tensioning bolt and re-position the band as needed. Remember don't rotate the band; only slide it up or down as needed. If the bands are at the upper or lower limits then you have the small vertical slot in the lower rear hinge bracket that you can adjust downward. Re tighten all 4 of the lower rear hinge bracket nuts first then the upper 4 nuts. Now return to step 7 and continue from there.

Step 9: With the hinge attaching hardware properly tightened, you need to check the bottom to dome gasket seal. You do this by fully opening the dome (read CAUTION below) and placing a dollar bill centered lengthwise across the bottom gasket then close the dome on it. Now slowly pull the dollar bill out and you should feel some resistance, this indicates the gaskets are making good contact. The slightest resistance will provide a good seal especially after the gaskets compress after use. You should perform this test at 4 points front, rear and both sides. When you have a good seal at all four points proceed to step 10.

Caution: The dome is heavy and difficult to open until the assist springs are installed; it also has a rapid weight transfer when closing that could catch you off guard. We recommend you use both hands until you get comfortable with the opening and closing cycles.

On the rare occasion that the gasket seal test would fail, take note of the area that isn't sealing properly. If the area is at the rear of the egg, inspect the rear hinge assemblies to make sure nothing is binding or that the upper hinge bracket isn't contacting the lower bracket thereby holding the dome up. Open the dome fully and inspect both gasket surfaces for foreign material or irregularities that may prevent the dome from sealing. Perform the seal test again if you have a good seal proceed to step 10. If the problem persists contact your Big Green Egg dealer for assistance.

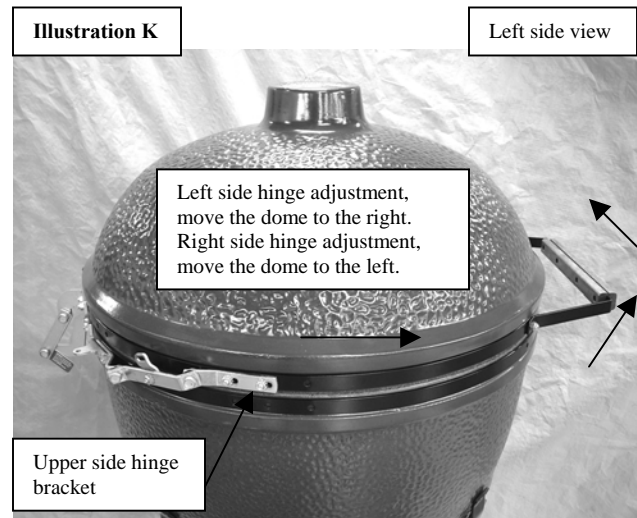
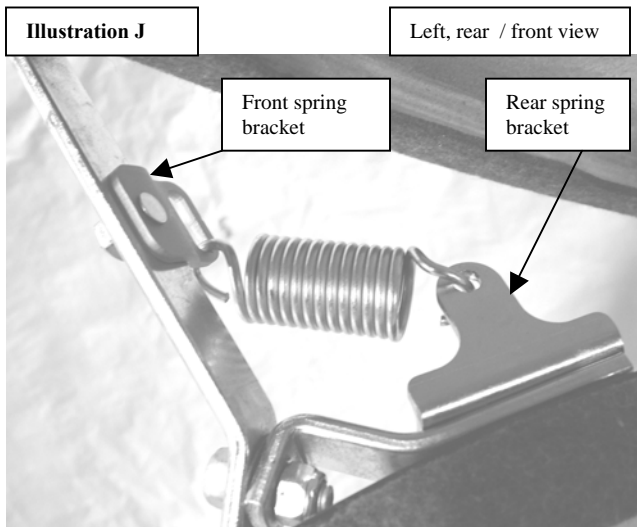
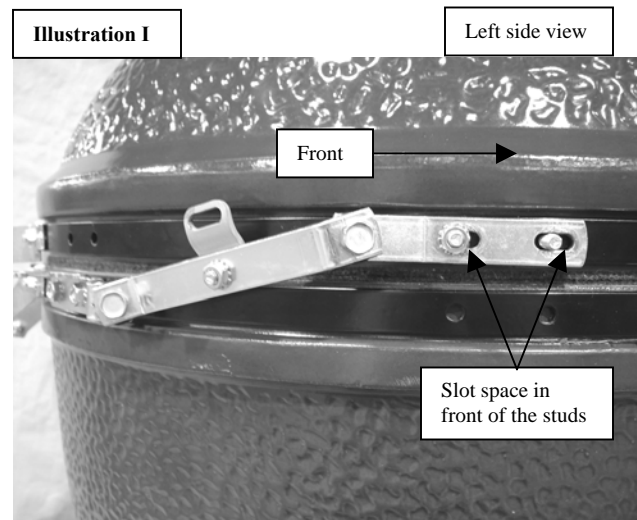
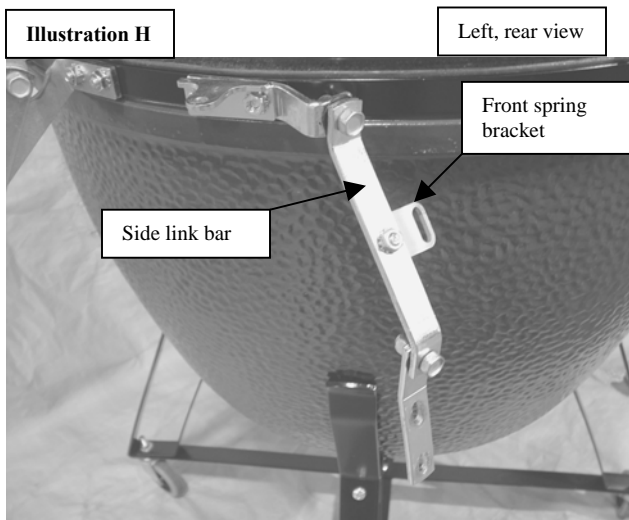

Step 10: Fully open the egg dome. Insert one hook end on the spring downward through the round hole in the rear spring bracket, then the opposite hook end downward through the slotted hole in the front spring bracket. The spring should be hanging in place and your assembly should look like (**Illustration J**). Repeat this for the opposite side of the egg. Now carefully close the dome. Open and close the dome several times to familiarize yourself, this also allows the parts to seat in place. Perform the gasket seal test once again the same as you did earlier.

It's not uncommon for the gasket seal test to fail at the rear of the egg this is easily remedied. The dome needs to be allowed to travel slightly more forward. Fully open the dome and remove both springs (*never attempt to make this adjustment with the springs installed*). Then carefully close the dome (*Remember it will be heavy without the springs*). Completely loosen both nuts on the upper side hinge bracket on the left side of the egg only. Put a piece of tape or make a pencil mark on the upper side hinge bracket along the back edge of one of the nuts to mark the current position in the slot. If you are using an egg nest block the casters so the nest won't move. Stand to the left of the lift handle at the front of the egg. Grasp the lift handle and gently slide / push the dome to the right side of the egg as you watch the studs in the upper side hinge bracket. The studs should move forward in the slotted hinge bracket as you move the dome. (**Illustration K**) Move the studs about 1/8" forward in the slots from their original location. Tighten both nuts securely and repeat this process on the right side of the egg. Remember, you will move the dome to the left when adjusting the right side hinge bracket. After you complete the right side adjustment, you can open the dome and re-install both springs as you did earlier. When both springs are in place you can open and close the dome several times and then repeat the gasket seal test. If the gaskets are still loose at the rear, **remove the springs** and repeat this process to move the dome further forward in the upper side hinge brackets. Install the black vinyl protective caps onto the ends of the spring hooks and you are done (**Illustration L**).

Illustration L

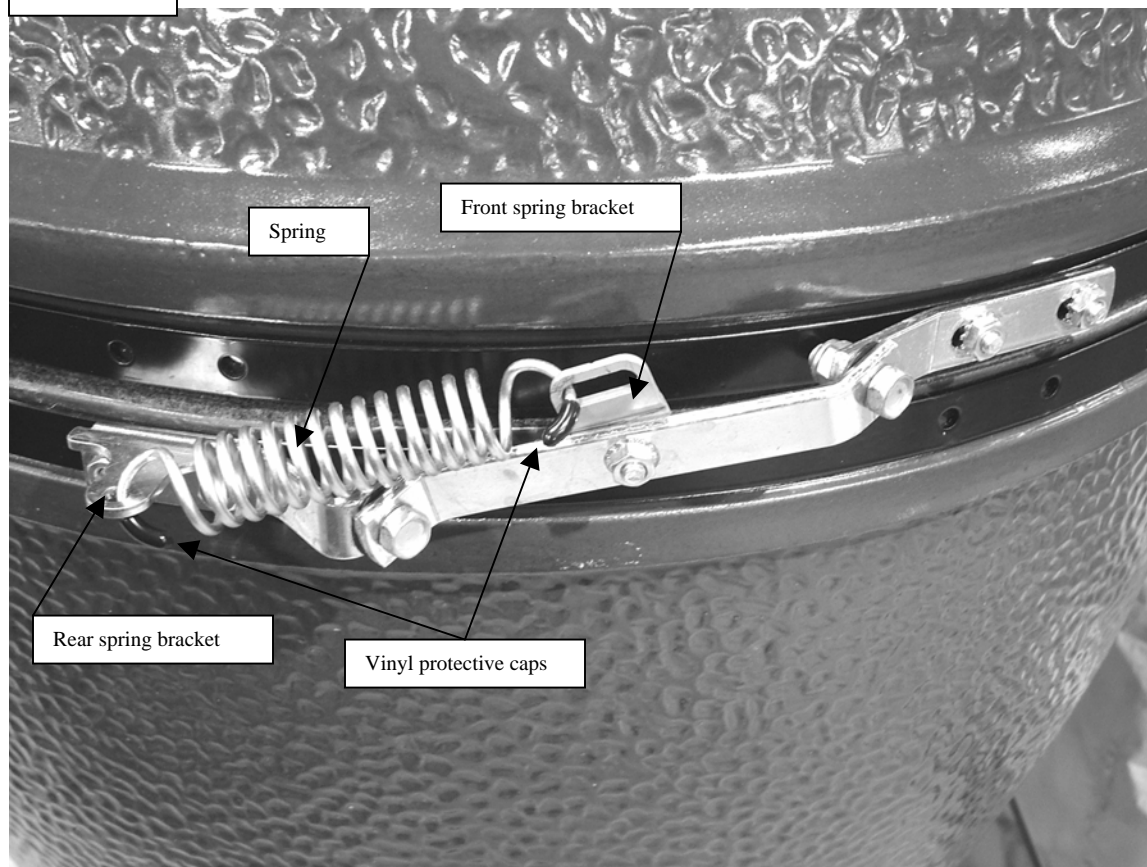

Congratulations, you have completed the hinge / band installation. Periodically lubricate the (8) pivot points on the hinge mechanism with light oil (penetrating lubricants such as WD 40 are not recommended) and it will provide you many years of trouble free service. Thank you for your purchase; this product was designed & manufactured in the U.S.A. exclusively for Big Green Egg.

IMPORTANT: You must check the band bolts and the hinge / band bolts for tightness regularly, especially after each of the first two or three uses. Failure to follow these instructions may cause the dome to slip out and break; this will not be covered under warranty. (NEVER TIGHTEN THE BANDS WHEN THE GRILL IS IN USE)

Caution: Extension springs are a source of energy and should be removed before making any adjustments to your hinge / band assembly or personal injury could occur.

SAFETY WARNINGS

- ▲ **Do not lift or transport the egg assembly by grasping the handle or hinge mechanism.**
- ▲ **Do not move the egg over rough or uneven surfaces, or by pulling the handle.**
- ▲ **Do not place your hands inside the egg until the lid is completely open.**
- ▲ **Periodically lubricate the hinge mechanism to insure proper functioning.**
- ▲ **Do not place hands / fingers in or near the hinge mechanism, many pinch points exist.**
- ▲ **Do not allow children to play with or operate the egg.**
- ▲ **Do not allow untrained persons to operate the egg.**

Big Green Egg

BGEXLBW/SA 8-24-07

3417 Lawrenceville Hwy. Tucker, GA 30084-5802

Phone: 770-938-9394 Fax: 770-938-9149 Website: www.biggreenegg.com